

## Basic Troubleshooting

### LED not displayed

Check the power source is at correct voltage and correct polarity.

### Display appears scrambled

Check that all connections are correct and tight.  
Check that there is no harsh interference nearby.

### Just display 999

Voltage out of range.  
Check the connection of signal cable.

## Panel Cutout

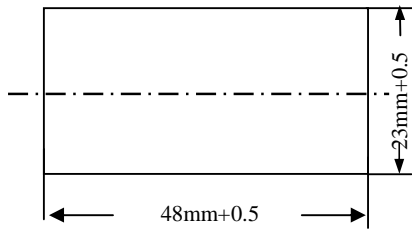

Distributed By Altronics Pty Ltd  
Perth, Western Australia  
[www.altronics.com.au](http://www.altronics.com.au)

## Q 0585 Digital Voltmeter

Power Source DC8-30V measure DC8-30V

### FEATURES:

- Ultra-bright LED display
- Polarity: Automatic sensing
- Automatic Calibration upon zero reading for 0V input
- High accuracy and low cost
- Easy to install
- Re-calibrated by adjusting the calibration potentiometer
- Ideal for auto, boat, industrial, commercial & domestic uses
- Decimal Point Position can be selected by user

### OPERATION SPECIFICATIONS:

Power Source	DC8-30V
Maximum Count	999 (3 digit)
Operating Temperature	0° to 55°C
Storage Temperature	-10° to 80°C
Relative humidity	20%~80%
Weight	30-35g
Dimension	W50mm x H26mm x D23.5mm
Panel Cutout	48mm×23mm
Sample Frequency	400ms

### WIRING DIAGRAM:

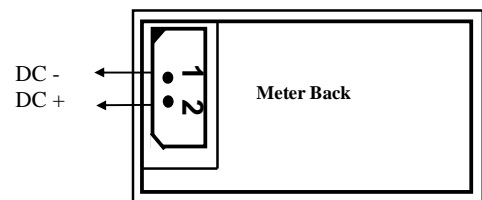

PIN 1: DC8~30V + (Positive pole)

PIN 2: DC8~30V - (Negative pole)

### CAUTION

- Do not disassemble
- Do not reverse polarity

### PARAMETER

Model	Range	Resolution	Accuracy
Q 0585	DC8-30V	100mV	±0.3%+1digit