

THE INSTRUCTION FOR FIELD INSTALLATION CONNECTOR

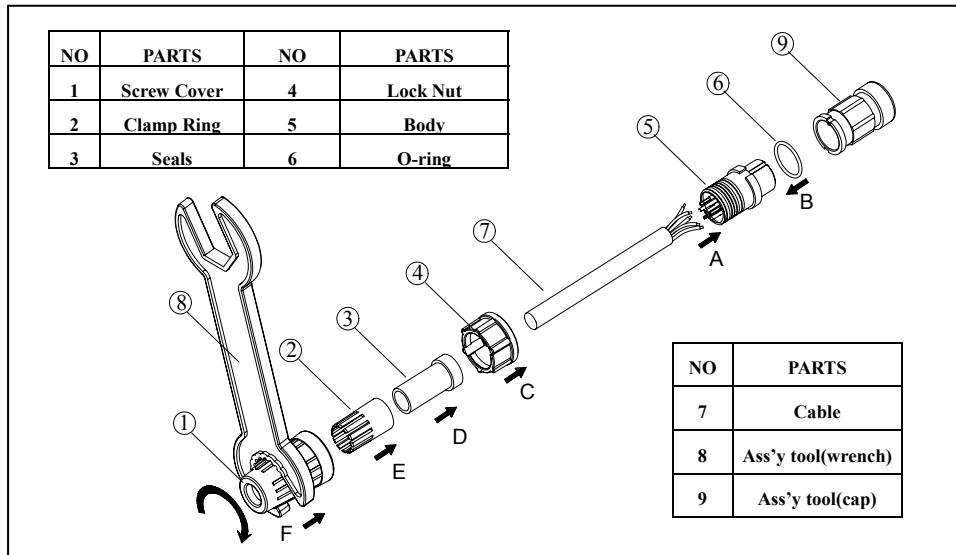

TIP: FOR LONG CABLE, IT IS SUGGESTED THAT THE PARTS (C, D, E, AND F) CROSS THROUGH CABLE BEFORE INSERTION INTO BODY.

<p>Step 1: strip cable sheath & insulation (7).</p>	<p>Step 5: insert seal(3) into clamp ring(2).</p>
<p>Step 2: solder conductors to allocated contacts.</p>	<p>Step 6: insert into screw cover(1).</p>
<p>Step 3: insert O-ring(6) into connector body.</p>	<p>Step 7: Tighten screw cover with hand tool(9) (Optional) or your hand while holding Ass'y tool(8) (Optional)</p>
<p>Step 4: insert lock nut(4) into body.</p>	<p>Note:</p> <ol style="list-style-type: none"> 1. Ass'y tool (cap) help to ensure good locking of screw Cover into the connector body. 2. Ass'y Hand Tools (cap & wrench) are sold separately.