

Mini Satellite Speaker

Operating Instructions



The perfect solution for home or commercial applications where sound and size matter. These smooth sounding, discrete speakers deliver a rich and full sound. Featuring a strong ABS enclosure ensuring longevity, coupled with a flexible and easy to install mounting arrangement.

Features

- Wool paper cone woofer for smooth and accurate audio reproduction
- Rugged ABS Enclosure for long lasting performance
- Adjustable Ball-Joint Mounting Bracket
- Phoenix type connector included to ensure perfect connection

Specifications

- Woofer Type: 2.75" Paper Cone
- RMS Power: 10W
- Frequency Response ($\pm 3\text{db}$): 100Hz-20kHz
- Sensitivity: $85\pm 3\text{dB}$
- Nominal Impedance: 8Ω
- Product Dimension: 94x83x118mm
- Product Weight: 0.5kg

Box Contents

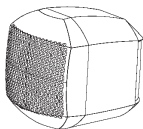

passive speaker X2



rubber stopper X2



ball-joint bracket X2



phoenix connector X2



screws X8



screws X8



user manual

Installation

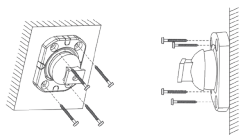

1. Fix the bracket to the wall

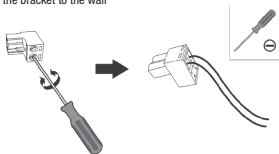

2. Connect the speaker wire

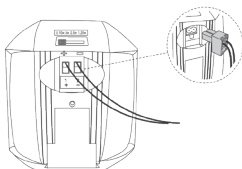

3. Attach the phoenix connector to the speaker

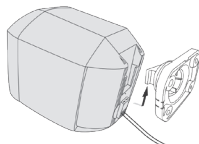

4. Attach the speaker to the bracket

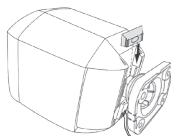

5. Attach the rubber stopper

Underpower vs. Overpower

1. Most speaker damage is caused by amplifiers with too little power wattage.
2. An overdriven amplifier clips the waveforms and leads to speaker distortion.
3. Clipping is usually audible and it may vary from a harsh sound to a fuzzy unclear sound.
4. If you hear the clipping at high volume levels, turn down the volume until the distortion is gone.
5. Damage caused by operating the speakers at distorted volume levels is not covered by the warranty.

Safety Instructions

1. When the speakers are installed on the walls, ensure the wall structure is reliable and that the speakers are firmly attached.
2. Install the speaker in a location that can structurally support the weight of the speaker and its mounting hardware. Otherwise it may result in the unit falling down and causing personal injury.
3. Do not use nails, adhesives or other unauthorized devices. Long-term use and vibrations may cause it to fall easily.
4. Do not touch or bump the woofer and tweeter. If these are damaged, the sound will be distorted.
5. Do not listen to sound at a very high level when you are changing the input source (for example, to tune FM/ CD) Installation or removal of cables should make sure that the power amp/ amplifier device radio is turned off.

Care and Maintenance

- Make sure to turn all equipment off before cleaning.
- The cabinet only needs occasional dusting. Please do not touch the drive units.
- Do not attempt to clean the speakers with chemical solvents as this may damage the paint surface.
- Clean with a dry cloth.