

# C 2143 (10 pack) 100mm One-Shot Reinforcement Panel Installation

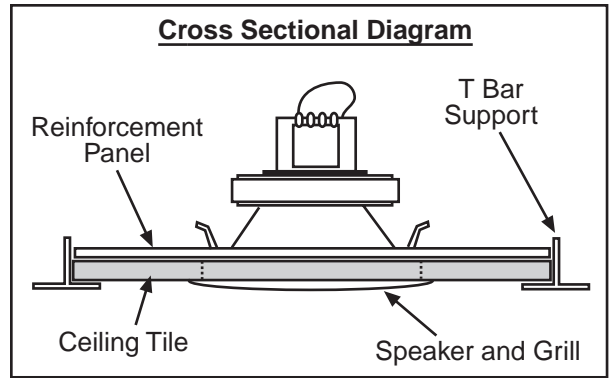
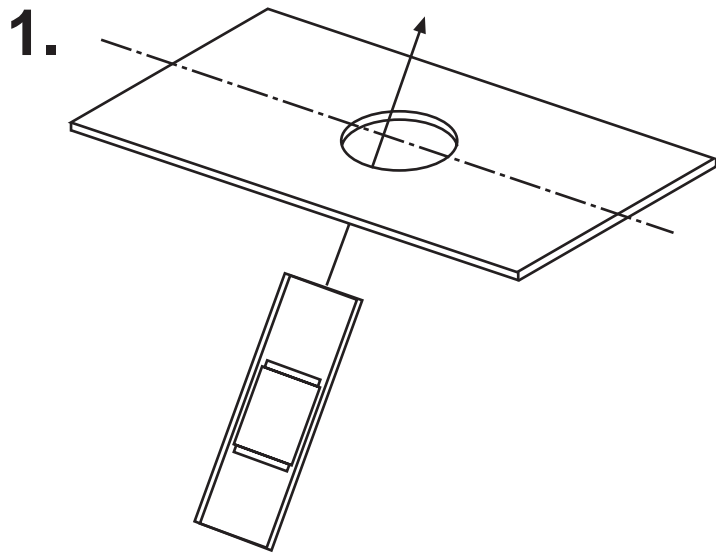

## Step 1

Note: Tile can be left in ceiling for this process.

Mark out your speaker hole ensuring hole is central in the width of the tile (eg: it MUST be centred across the short side of the tile)

Cut hole in ceiling tile. Slide the reinforcement panel up through the hole.

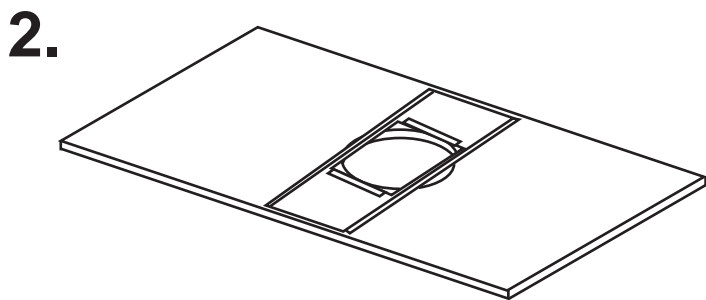

## Step 2

Position the reinforcement panel across the width of the ceiling tile.

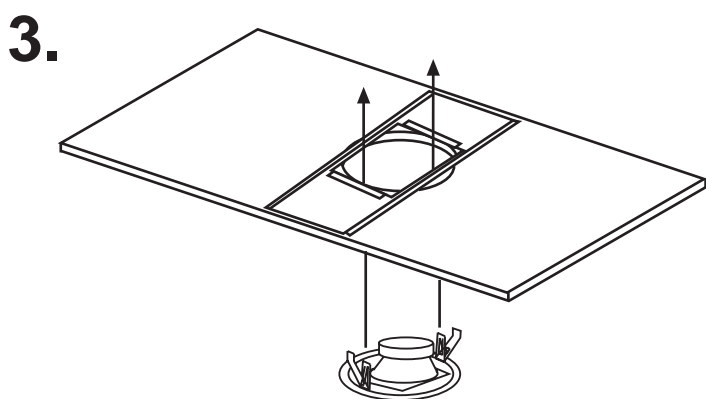

## Step 3

Connect speaker wires as necessary and install speaker into hole. Ensure the "One-shot" clips line up with the rounded metal edges of the reinforcement panel.

Push upward until speaker clicks into place securely

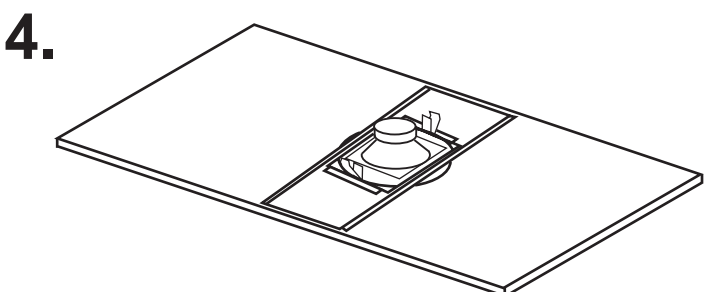

Your speaker should now be installed as shown. The reinforcement panel will provide extra support to reduce sagging and tile damage.

# C 2129 (10 pack)

## 200mm One-Shot Reinforcement Panel Installation

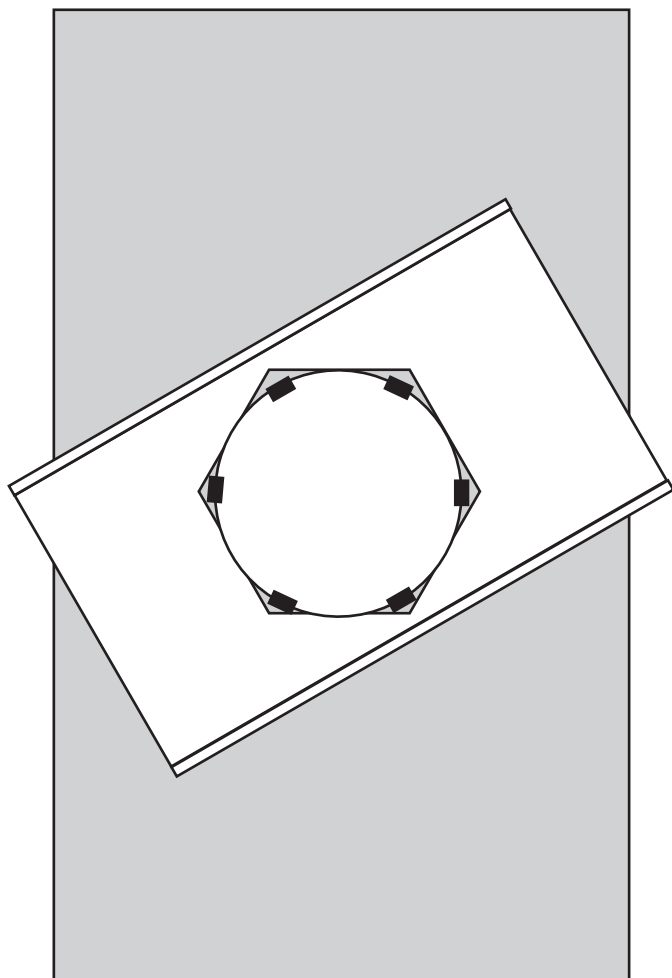

### Step 1

Note: Tile must be removed from ceiling for installation process.

Mark out your speaker hole ensuring hole is central in the width of the tile (eg: it MUST be centred across the short side of the tile)

Cut hole and install speaker into it. Once this is done lay the tile face down and place the reinforcement panel over the top of the tile at a 60 degree angle.

**The “One-Shot” clips should line up in the corners of the hexagonal hole in the centre of the panel.**

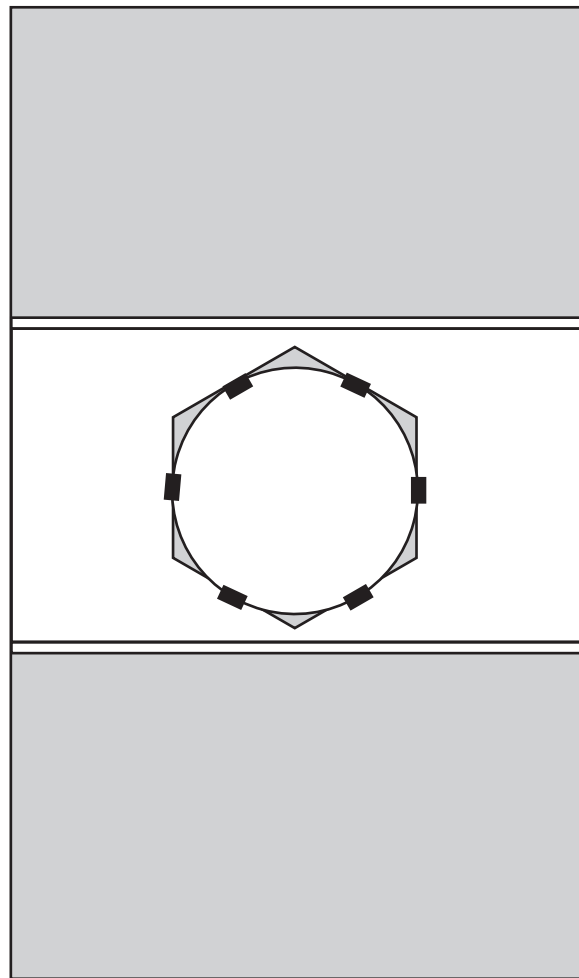

### Step 2

Grasp both ends of the speaker panel firmly. Twist 30 degrees so that the panel lines up with the width of the ceiling tile (as shown).

**The “One-Shot” clips should now line up on the flat faces of the hexagon hole in the centre of the panel.**

The entire assembly can now be refitted to the ceiling.

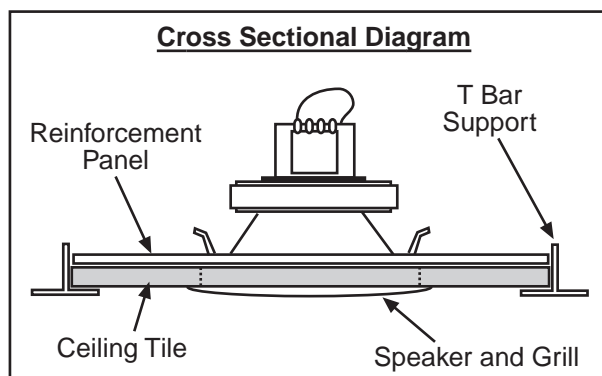

**Speaker Mounting Clip**



**Ceiling Tile**



**Reinforcement Panel**

# C 0699 (10 Pack) 100mm One Shot Surface Mount Conduit Adaptor Installation

