

DisplayPort 1.4 8K Bi-Direction Switch

Quick Installation Guide Ver. 1.0

All brand names and trademarks are properties of their respective owners

INTRODUCTION:

This DisplayPort switch is a manual bidirectional switch for connecting different devices with DisplayPort port. This switch offers two different applications.

- Up to 2 devices can be connected to a monitor, TV or projector. At the push of a button the device that is displayed on the screen can be selected.
- A DisplayPort device can be connected to up to 2 screens. The screen on which the signal is displayed can be selected at the touch of a button. Simultaneous output to multiple screens is not possible.

FEATURES:

- Compliant to link with all DisplayPort input and output
- Complies with DisplayPort 1.4 specification
- Supports: 8K@30Hz
5K@60Hz
4K@120Hz、60Hz
1440P@165Hz、144Hz、120Hz、60Hz
1080P@165Hz、144Hz、120Hz、60Hz
(Depending on the system and the connected hardware)
- Supports OS: MAC OS X, Windows
- Supports HDR
- Supports 4:4:4,4:2:2,4:2:0

PACKAGE CONTENTS:

Before attempting to use this unit, please check the packaging and make sure the following items are contained in the shipping carton:

- 1 x Bi-direction Switch
- 1 x USB power cable
- 1 x User Manual
- 1 x Warranty Card

1

2

PANEL DESCRIPTIONS:

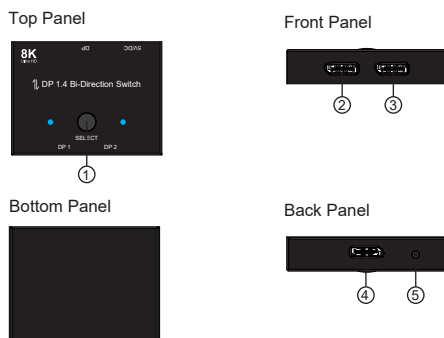

- ① Switch Key
- ② Input or Output: DisplayPort Female(DP 1)
- ③ Input or Output: DisplayPort Female(DP 2)
- ④ Input or Output: DisplayPort Female(DP)
- ⑤ Power: DC Jack(DC/5V)

CONNECTION DIAGRAM:

Function 1

1. For the installation of the hardware all devices should be turned off.
2. Connect all video sources and the switch ports 1 + 2 with optional cables.
3. Connect the switch to your display with an optional cable.
4. Turn on all connected devices.
5. By using the button on the top you can switch between the different video sources.

Function 2

1. For the installation of the hardware all devices should be turned off.
2. Connect all displays and the switch ports 1 + 2 with optional cables.
3. Connect the switch to your video source with an optional cable.
4. Turn on all connected devices.

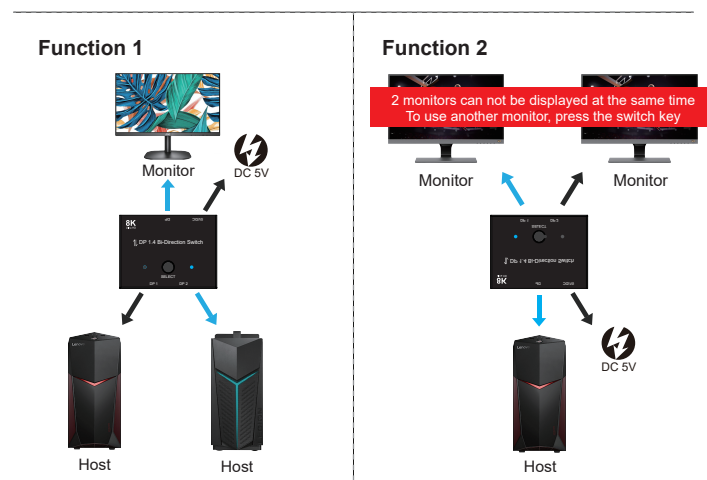

3

4