

## INSTALLATION MANUAL

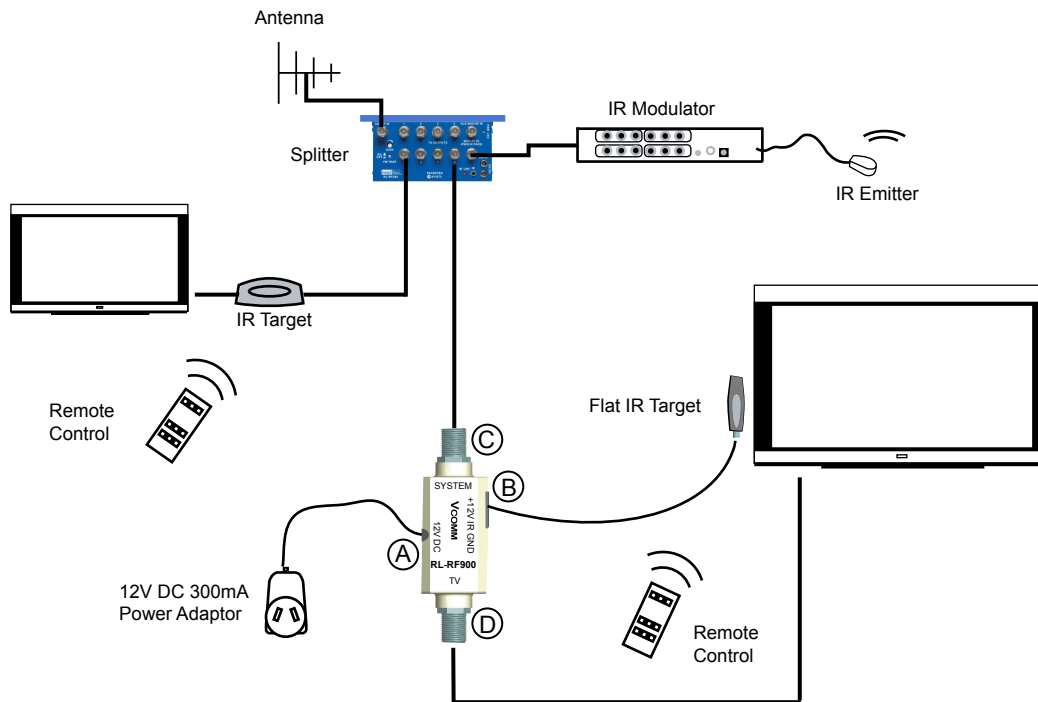

### Hardware Connection

1. Connect Flat IR Target (RL-IR500) or Tube IR Target (RL-IR600) to the target input terminal on the side of the RL-RF900 (B). Place the target in a position to receive IR commands. LED indicator on IR Target will illuminate briefly upon receipt of IR command.
2. Connect F connector marked 'system' (C) to an output of the RL-RF380 splitter.
3. Connect the F connector marked 'TV' (D) to the aerial input of the TV.
4. Connect included power supply to DC input jack (A) on side of RL-RF900.
5. Once installation is complete switch on power to all equipment.

- (A) DC Jack
- (B) Target Input terminal
- (C) F connector to System
- (D) F connector to TV

Power input	12V DC 300mA
Connectors	2 x coaxial
	1 x IR termination
Size (mm)	80 x 28 x 20

### WARRANTY

Vcomm Pty Ltd states that the warrant that the customer can rely on is that provided by the manufacturer. In the event of any warranty claim please contact us and we will forward it to the manufacturer. The manufacturer will then determine the extent of their liability. This expressly negates, to the extent possible by Australian law, any warranty reliance on Vcomm Pty Ltd.

