

▼ Wireless Audio

**Bluetooth V4.1 Audio Aux Receiver**

Add bluetooth wireless audio streaming to headphones, speakers or even vehicles. Plug in the 3.5mm jack socket to jack socket adapter for speaker and vehicle use. Provides buttons for adjusting volume & tracks. Bluetooth 4.1 provides CD quality sound output with low latency to ensure audio is in sync with video (if used). Includes USB cable for charging.



Can operate whilst being charged unlike other models on the market

**Features** • Bluetooth 4.1 for high audio quality with low latency • Up to 4 hours listening time between charges • 30 min recharge time • Internal lithium battery is rechargeable via standard micro USB • Compact design weighs less than 8 grams • Integral pocket clip

Price Each	RRP	2+	4+
<b>AE1101</b>	<b>19.95</b>	<b>17.95</b>	<b>15.95</b>

**2 Zone Bluetooth Audio Extension System**



new for 2019

This system provides a remote Bluetooth wallplate allowing you to stream audio wirelessly from your devices in one room whilst your audio equipment/ amplifier is located in another. Each plate connects to standard UTP cabling to relay audio signals back to the amplifier through the A 4850 plate receiver without loss of quality. The A 4850 wall plate receiver allows for two wallplates to be connected for two independent audio signals. Power for the wallplates is provided over the UTP cabling (max range 100m). Supplied fitted to an Altronics dual cover wallplate with fascia plates to suit your existing decor.

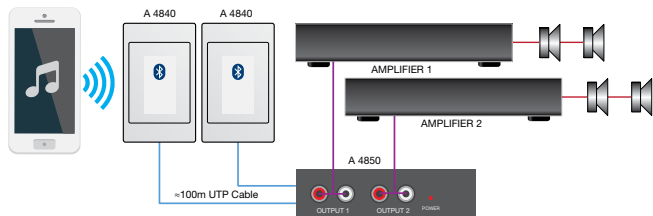

Price Each		RRP	2+	4+
<b>A 4850</b>	Wall plate receiver	<b>195.00</b>	<b>179.00</b>	<b>169.00</b>
<b>A 4840</b>	Bluetooth wall plate	<b>109.00</b>	<b>99.00</b>	<b>89.00</b>

**Bluetooth Wallplate 2x15W Amplifier & Music Player**

A compact wallplate designed to fit a standard electrical wallbox, which features a 2 x 15W RMS (into 4 ohms) internal amplifier with Bluetooth wireless receiver. Ideal for connecting speakers in your lounge room, kitchen or study, it can stream music directly from your smartphone or tablet. Also features an FM tuner, auxiliary 3.5mm jack, USB and SD card inputs for MP3 playback. It could also be used in reception areas for general background music and audio advertising in commercial installations. Includes IR remote control. Requires 12V DC power supply.



Price Each		RRP	2+	4+
<b>A 1100</b>		<b>129.00</b>	<b>119.00</b>	<b>105.00</b>
<b>M 8937C</b>	12V DC 3A plugpack to suit	<b>29.95</b>		

▼ Signal Distribution

**Audio Signal Distribution System**



A 4821

A 4825

Rear Connections



A 4832

Distributed audio signals over UTP cabling are becoming increasingly widespread in large building installations and multi-function venues. This suite of products, used together provide a connected solution for local zone inputs, feeding signals back to centrally located zone amplifiers. The system uses a proprietary standard called CSP which can be easily converted to the widely adopted Dante standard using the A 4830/A 4831 converter boxes. Wallplates can also be used in a stand-alone point to point basis, allowing balanced and unbalanced signals to be sent over long distances (up to 600m depending on cable used and configuration of plates). To simplify installation power is only required at one end of the cable run and most plates can be daisy-chained to additional plates. Each standard electrical wallplate is provided with the Altronics dual cover fascia to suit existing installation decor.

**A 4832 Example System Diagram**

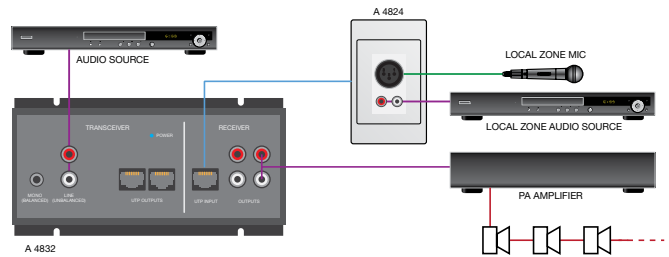

**Dante Connection via A 4830**

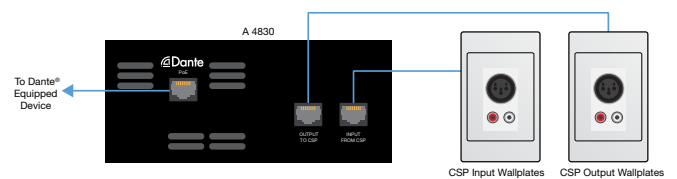

**Features** • CSP transfer protocol with Dante compatible converters available • Suitable for balanced and unbalanced signals • Daisychain topology loop outputs (on most models) • Local power input (powered at one end of cable run) • Adjustable mic input gain

Price Each		RRP	2+	4+
<b>Input Wall Plates</b>				
<b>A 4820</b>	XLR input	<b>185.00</b>	<b>169.00</b>	<b>159.00</b>
<b>A 4821</b>	Stereo RCA / 3.5mm input	<b>195.00</b>	<b>179.00</b>	<b>169.00</b>
<b>A 4822</b>	Stereo RCA input	<b>185.00</b>	<b>169.00</b>	<b>159.00</b>
<b>A 4824</b>	XLR / Stereo RCA input	<b>205.00</b>	<b>189.00</b>	<b>179.00</b>
<b>A 4825</b>	Dual XLR input	<b>285.00</b>	<b>265.00</b>	<b>249.00</b>
<b>Output Wall Plates</b>				
<b>A 4826</b>	XLR / Stereo RCA output	<b>199.00</b>	<b>185.00</b>	<b>175.00</b>
<b>A 4827</b>	XLR output	<b>185.00</b>	<b>169.00</b>	<b>159.00</b>
<b>A 4828</b>	Stereo RCA output	<b>195.00</b>	<b>179.00</b>	<b>169.00</b>
<b>Interface Boxes</b>				
<b>A 4832</b>	Local input/output hub	<b>240.00</b>	<b>219.00</b>	<b>199.00</b>
<b>A 4830</b>	Dante input/output converter	<b>499.00</b>	<b>449.00</b>	<b>399.00</b>
<b>A 4831</b>	Dante 2 input / 4 output converter	<b>795.00</b>	<b>719.00</b>	<b>639.00</b>