

Specification Sheet

Release Date:

Manufacturers please note, we recommend that a sample is obtained to confirm suitability. Specifications subject to change without notice.E&OE. © Altronic Distributors Pty. Ltd. ABN 84 177 396 871

Altronics Part Number	Description	Supplier Info
S4250B	AC/DC 10A SPST PCB Relay 12V	JZC-32FAZ10DC12V, 0.45 ROHS
S4252B	AC/DC 10A SPST PCB Relay 24V	JZC-32FAZ10DC24V, 0.45 ROHS

Features

- 10A switching capabilities.
- SPSTNO configuration.
- Subminiature, standard PC layout.
- Sealed & Unsealed types available.

Contact Data

Contact Arrangement: 1A(SPSTNO)

Contact Material: Silver Alloy

Contact Rating (resistive): 10A/125VAC, Motor load:1/4HP 277VAC, Lamp load:TV-5

Max. Switching Power: 150W 1250VA

Max. Switching Voltage: 30VDC 277VAC Max.Switching Current:10A

Contact Resistance or Voltage drop: <100mΩ item 4.12 of IEC 61810-7

Operational Life:

- Electrical: 10⁵ Item 4.30 of IEC 61810-7

- Mechanical: 10⁷ Item 4.31 of IEC 61810-7

Coil Parameters

Part Number	Coil Voltage VDC		Coil Resistance Ω±10%	Pick Up Voltage VDC (max) (75% of rated voltage)	Release Voltage VDC (min) (5% of rated voltage)	Coil Power Consumption W	Operation Time mS	Release Time mS
	Rated	Max						
S 4250B	12	15.6	320	9.00	0.60	0.45	<8	<5
S 4252B	24	31.2	1280	18.00	1.20	0.45	<8	<5

CAUTION:

- 1.The use of any coil voltage less than the rated coil voltage will compromise the operation of the relay.
- 2.Pickup and release voltage are for test purposes only and are not to be used as design criteria.

Operation condition

Insulation Resistance	100M Ω min (at 500VDC)	Item 7 of IEC 60255-5
Dielectric Strength		
Between contacts	50Hz 1000V	Item 6 of IEC 60255-5
Between contact and coil	50Hz 2500V	Item 6 of IEC 60255-5
Shock resistance	100m/s ² 11ms	IEC 68-2-27 Test Ea
Vibration resistance	10~55Hz double amplitude 1.5mm	IEC 68-2-6 Test Fc
Terminals strength	10N	IEC 68-2-21 Test Ua1
Solderability	230 $^{\circ}$ C \pm 2 $^{\circ}$ C 3 \pm 0.5s	IEC 68-2-20 Test Ta method 1
Ambient Temperature	-40~70 $^{\circ}$ C	
Relative Humidity	95% (at 35 $^{\circ}$ C)	IEC 68-2-3 Test Ca
Mass	6g	

Safety approvals

Safety approval	UL & CUR	TUV	CQC
Load	6A/120VAC;10A/125VAC 5A/240VAC,250VAC 4.2A/277VAC TV-5 1/4HP/277VAC 250VAC 240VAC 120VAC	5A/250VAC,28VDC	5A/250VAC

Dimensions

mm /inch

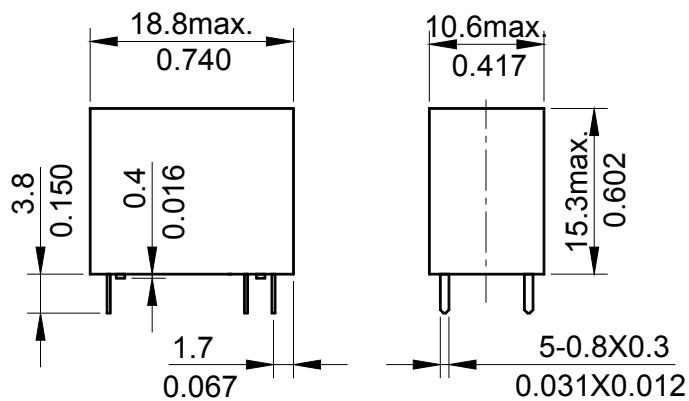

Dimensions

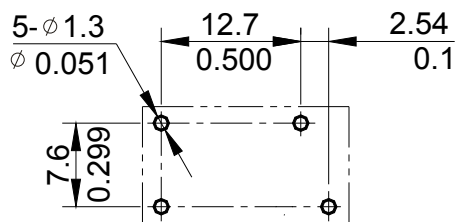

Mounting (Bottom view)

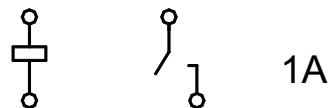

Wiring diagram
(Bottom view)

NOTES 1).Dimensions are in millimeters.
2).Inch equivalents are given for general information only.